

# MRS

## QUICK USER GUIDE



## GX-5

---

DIGITAL MODELING AMPLIFIER FOR GUITAR & VOCAL

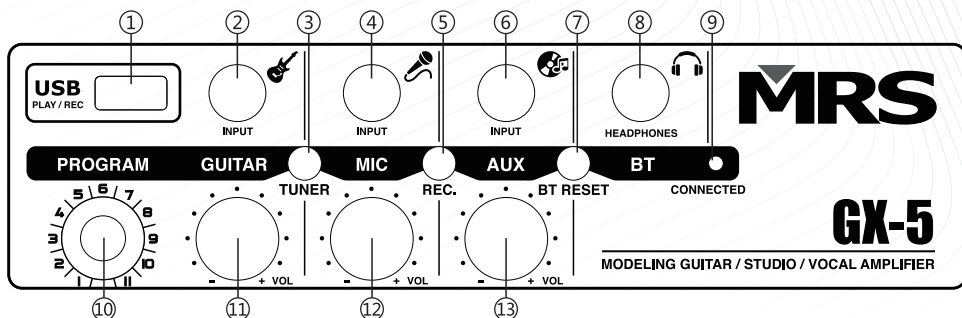

- 1 Connect with USB device**  
Plug and Play your music, you can control through MRS APP.
- 2 Instrument input**  
TRS to connect the instrument (including guitar, bass, Sax, piano ect.).
- 3 Tuner button**  
- Plug in the guitar, press the tuner button shortly to enter tuner mode.  
- Pluck the strings, red LED in Bass and blue LED in treble. Corresponding string glittering, indicator to "b" means low tone, indicator to "#" means high tone  
- When the string closer to the value, red/blue LED glittering more quickly to always on.  
- Tuner doesn't finish until red and blue LED lighting together without glittering. Repeat on each guitar string to finish tuning.  
- Notice : Stop playing and mute your instrument for 20 seconds, if Tuner is not recognised. Then turn the volume of instrument up before tuning again.
- 4 Microphone input**  
TRS to connect microphone
- 5 Record button**  
- Plug USB in non-tuner mode, press Rec button shortly, then amplifier begin to record after 2 seconds. When red LED always on, press Rec button shortly again to stop. Finished recording will play immediately.  
- When the recorded track is playing, long press REC button on the top panel of amplifier for 2 seconds, the recorded track will be DELETED. Red light will shine 3 times to notice. Latest recording track will play immediately.  
- NOTICE : USB Music will NOT be included in the Recording.
- 6 AUX input**  
TRS to connect your audio device with LINE level
- 7 BT Wireless reset button**  
Press BT Wireless reset button shortly in non-tuner mode, blue LED glittering, reset complete after blue LED turn off.
- 8 Headphone output**  
3.5mm Mini Headphone Connector Output
- 9 BT Wireless LED**  
BT Wireless signal and indicator
- 10 PROGRAM mode**  
Select your program between 1-11 places.
- 11 Instrument channel volume knob**  
Adjust your Instrument input level
- 12 Microphone channel volume knob**  
Adjust your Microphone input level
- 13 Music channel volume knob**  
Adjust your audio device input level
- 14 Power ON/ OFF button**  
Switch ON/OFF your amplifier
- 15 Voltage conversion switch**  
- Switch 110V/220V of your amplifier according to your current power supply.  
- NOTICE : Check your current power supply before plug in your power cord. Check your current amplifier voltage to confirm they are the same as your local power supply.
- 16 Power input**  
Connection for power source

# QUICK USER GUIDE



IOS:  
<https://mrs-audio.com/app-ios/>



Android:  
<https://mrs-audio.com/app/>

## DOWNLOAD

Download the application in iOS/ Android phone by scanning the QR code on the right or download special APP ( suggest Android use browser to scan).



Notice : allow location access information to connect unit that close to your device while using the APP.

Notice : MRS-AUDIO APP available on phone unit only.

## Get Started

Open MRS-AUDIO APP on your mobile device.

Press MRS logo to get our information



After open MRS-APP, press the CONNECT button on the top right corner.

Choose GX-5\_Control, connect and start to use MRS logo will turn white when connected on Homepage.

Notice : There will be User config at the first time, please waiting until the configuration finish.



Program mode: effect mode knob, choose mode(1-11 gear).

TUNER: press to enter tuner mode.

USER: press to enter the interface of customization on user memory.

LOAD: press customized mode to corresponding knob gear.

Press > to enter guitar channel interface, adjust instrument level and volume.

Press > to enter microphone channel interface, adjust microphone volume.

Press > to enter USB/ BT Wireless music channel interface, adjust music volume.

Press > to enter REVERB adjustment interface.



### How to create your own sound 1

To hear any effect you give to your sound you will need to increase the volume and effect level Knob button on the guitar section of the main page

Press > button create your own guitar sound



Adjust Knobs inside AMP to get your own sound

Choose the type of AMP you need by sliding your finger to the right or left on the image of the AMP



Then go MOD (by touching with your finger)

Adjust Knobs inside MOD to get your own sound

Notice : Different possibilities appear Flanger, Chorus, Vibrato etc ...

Sliding your finger to the right or left on the image of the MOD. Then you can switch between different MOD.

Notice : These modulations are not chain, the last one you choose leaving MOD will be the one you choose



## How to create your own sound 2



Go to DELAY (by touching with your finger)

Adjust Delay detail as you want by touching the Delay image on top.

Go to REVERB (by touching with your finger)

Adjust Reverb detail as you want by touching the Reverb image on top.

Go to EQ (by touching with your finger)

Adjust EQ detail as you want by touching the EQ image on top.

## How to save your own setting & programs 1

After set your own parameter setting (AMP, PROGRAMS, EQ, etc.)

Back to Homepage

Press USER and choose 11-30 memory box (which is not in red color)

Note: Memory box RED in color is default setting. You CAN NOT save any data in RED box.

Rename and Enter to save your own memory on certain box with box color.



Long press memory box and drag to the block to replace. Only 1-11 will be loaded on Homepage.

## How to save your own setting & programs 2

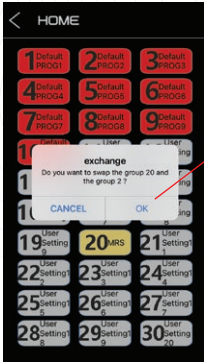

Confirm replacing the order.



Back to Homepage, turn Program mode knob to 2 (or the order you saved on previous step).



Press LOAD to start playing with your own settings / Programs.

Example preview:

Default Program 2

After customized User Program 2



### How to Record

(You can record directly by pressing the REC. button on Amplifier panel.)

Recording by MRS APP, you need to prepare your USB. An empty USB is recommended.

Plug in your USB drive in non-tuner mode of MRS GX5 Amplifier .

Press > on USB/REC/BT row.

Notice : Recording is not able to record with your USB MP3 at the same time.

Press REC button shortly, then amplifier begin to record after 2 seconds. REC button will turn red.

Press REC button again to finish your recording. Last recording will start to play immediately. And REC button will turn grey.

Press PLAY/PAUSE Button to stop playing.

Notice : If USB drive contains Music files, music will play immediately after plug in .

### DELETE RECORDING

When the recorded track is playing(or paused), long press REC button on the top panel of amplifier for 2 seconds, the recorded track will be DELETED. Red light will shine 3 times to notice on amplifier. Last recording track will play immediately.

### FUNCTIONS

Press Left Wheel to play backward of USB/REC music ONLY.

Press Right Wheel to play fast forward of USB/REC music ONLY.

Press Previous button to play previous music.

Press Next to play next music.

Volume control of current function.

Press function name to switch the control between USB MP3 / REC.&PLAY / BT WIRELESS

Notice : REC.&PLAY only play and save inside the REC folder on the USB Drive







## MICROPHONE Channel Control

Connect your microphone with GX5 Amplifier. You will need to increase or decrease the volume level of microphone.

Press > on the Microphone row

Adjust Master volume except Microphone. (Guitar, USB/REC/BT volume control)

Adjust microphone volume by sliding the knob up and down.

Adjust microphone effect level by sliding the knob up and down.

Notice : effect level is 0 when turn off.



Adjust ON or OFF of effect level by pressing Effect switch

Adjust ON or OFF of EQ module by pressing EQ switch (EQ is 0 when turn off).

EQ module, 7 sliders represent the gain value(db) of current frequency point. Calling out the timbre suit yourself by sliding different sliders.

Press RESET to reset EQ parameter as 0.



## REVERB

Press > on the REVERB row

Reverb type from left to right is: PLATE, ROOM and SPRING

Knob from left to right is: reverb effect level knob, reverb tone knob reverb time knob, adjust the corresponding parameter in REVERB mode.

## DELAY

Knob from left to right is : delay effect level knob, delay feedback knob and delay time knob, adjust the corresponding parameter in REVERB mode.

Notice : REVERB & DELAY are the same as Guitar section. You can control them on Guitar and Mic channel when the effect turned on.

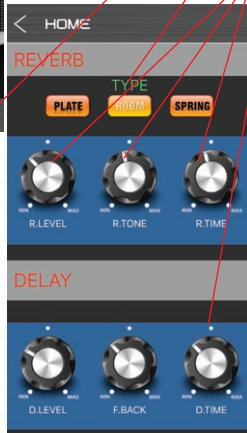

### Trouble Shooting

#### Version of iOS / Android systems supported

Android OS version: Android 4.3 or later  
iOS version: iOS 9.0 or later

#### Q1 Fault phenomenon :

Android App can not installed  
Installation Failure

#### Reason :

Not relevant device  
Not allowed to install third party apps  
Can not install Unknown Apps

#### Method :

MRS APP available on Android cell phone unit. Re-install your app with Android Phone unit.  
On your Android Phone. Navigate to Setting > Security. Check the option "Unknown sources". Tap OK on the prompt message. Select "Trust".  
Allocate your phone setting and Enable to install Third Party Apps

#### Q2 Fault phenomenon :

iOS App can not installed

#### Reason :

Link error or scanning not properly

#### Method :

Search "NEWMRS" on Apple App Store to find the latest MRS App  
Scan QR code with a brighter environment.

#### Q3 Fault phenomenon :

APP invalid

#### Reason :

BT Wireless break off  
Others

#### Method :

Exit APP, connect again.  
Reset if doesn't work

access while using APP

#### Q4 Fault phenomenon :

Turn on the power, no sound

#### Reason :

No audio input  
Volume is in min

#### Method :

Input music signal  
Adjust volume

#### Q5 Fault phenomenon :

Distortion

#### Reason :

APP with incorrect parameter  
Volume too loud  
Audio system maybe damaged

#### Method :

Adjust volume  
Check audio system, repair if damage

#### Q6 Fault phenomenon :

Instrument sound too low

#### Reason :

Instrument connector didn't insert completely  
Microphone volume is in min  
App with incorrect volume

#### Method :

Insert instrument plug completely in instrument channel  
Adjust instrument channel volume  
Turn on APP and operate correctly

#### Q7 Fault phenomenon :

Microphone no sound

#### Reason :

Microphone didn't connect well  
Microphone switch didn't turn on  
Microphone volume knob is in min  
App with incorrect volume

#### Method :

Insert microphone plug in microphone channel completely  
Confirm microphone switch in ON  
Adjust microphone channel volume  
Turn on APP and operate correctly

#### Q8 Fault phenomenon :

BT Wireless can't connect

#### Reason :

Paired with other device  
Others

#### Method :

Exit other device, connect again  
Reset equipment

#### Q9 Fault phenomenon :

Android APP keep on installing the old version

#### Reason :

Browser history / cache

#### Method :

Reopen the link with a another browser or refresh a few times before download the latest version.

#### Online Manual

[Please download updated manual on www.mrs-audio.com](http://www.mrs-audio.com)

## Technical Specifications

Model No.: MRS GX-5  
Power: AC 110-230V-50Hz/60Hz  
Speaker: 5.5 inch full frequency speaker  
Frequency response(-3dB): 70Hz-20kHz  
Dimension(Width \* Height \* Depth) : 280\*170\*115mm  
Weight : 2.45 kg

### Music Channel

Max output(W) (1 KHz, 3% distortion): 15 Watts  
Noise(mV)(Rated A weight) : 2  
S/N (Rated, 1 KHz input, THD 1%, A weight) : 71  
THD(%) (Main channel, rated, 1 KHz, A weight) : 0.1  
Frequency response(dB(A)) (Main channel, 20Hz-1 KHz-20KHz) : +-3  
Overload voltage(V) (Main channel, 1 KHz, THD 1%) : 1.1  
Sensitivity(mV)(1KHz, THD 3%) : 290

### Instrument Channel

Max output(W) (1 KHz, 3% distortion): 15 Watts  
Noise(mV)(Rated A weight) : 4  
S/N (Rated, 1 KHz input, THD 1%, A weight) : 65  
THD(%) (Main channel, rated, 1 KHz, A weight) : 0.2  
Frequency response(dB(A)) (Main channel, 20Hz-1 KHz-20KHz) : +-3  
Overload voltage(V) (Main channel, 1 KHz, THD 1%) : 0.4  
Sensitivity(mV)(1KHz, THD 3%) : 110

### Microphone Channel

Max output(W) (1 KHz, 3% distortion): 15 Watts  
Noise(mV)(Rated A weight) : 3  
S/N (Rated, 1 KHz input, THD 1%, A weight) : 67  
THD(%) (Main channel, rated, 1 KHz, A weight) : 0.1  
Frequency response(dB(A)) (Main channel, 20Hz-1 KHz-20KHz) : +-3  
Overload voltage(V) (Main channel, 1 KHz, THD 1%) : 0.22  
Sensitivity(mV)(1KHz, THD 3%) : 290

Design and specifications are subject to change without notice  
MRS is a registered trademark in Europe and other countries  
all other product or company names are trademarks or registered  
trademarks of their respective owners.

Copyrights MRS AUDIO, all rights reserved